

Frankenstein Mug Rug

Pattern for a
9" x 12" WoolFelt
Home Décor Project



Elizabeth Coughlin Designs
ecoughlindesigns.etsy.com
ecoughlindesigns.blogspot.com

Frankenstein Mug Rug

WoolFelt Home Décor Project - Finished size is approximately 9" x 12".

Copyright 2021 Elizabeth Coughlin

For personal use only, do not sell items made using these designs. Purchase of pattern does not constitute transfer of copyright or license for commercial usage. All Rights Reserved.

Elizabeth Coughlin Designs Blog:

ecoughlindesigns.blogspot.com

My Etsy Store:

ecoughlindesigns.etsy.com

Material Sources:

WoolFelt -

National Nonwovens

P.O. Box 150 Easthampton MA 01027

1-800-333-3469

<http://www.woolfelt.com/> (wholesale)

<http://www.commonwealthfelt.com/> (online retail).

Embroidery Floss -

The DMC Corporation

10 Basin Drive, Suite 130, Kearny, NJ 07032

(973) 589-0606

<http://www.dmc-usa.com>

WoolFelt & Matching Floss -

[Prairie Point Junction](#) (online retail).

Materials:

- National Nonwovens WoolFelt:
 - 12 x 18 sheet Field of Lilacs
 - One half of a 12 x 18 sheet Moss
 - One half of a 12 x 18 sheet Black
 - One quarter of a 12 x 18 sheet Old Gold
- DMC Six-Strand Embroidery Floss to match WoolFelt (use three strands at a time):
 - 155 to match Field of Lilacs WoolFelt
 - 937 to match Moss WoolFelt
 - 310 to match Black WoolFelt
 - 833 to match Old Gold WoolFelt
- Large-eyed chenille needle, straight pins, scissors, freezer paper, pen or pencil, glue stick, iron.

Instructions:

- Fold the Field of Lilacs WoolFelt 12" x 18" sheet in half crosswise. Press with an iron on the wool setting. Cut on fold line to have two 9" x 12" pieces. Put one piece aside for backing.
- Trace all pattern pieces onto freezer paper and cut out in the numbers indicated.
- To use the freezer paper templates, place them shiny side down on the WoolFelt. Set the iron to the wool setting with no steam; the iron must be dry. Iron the freezer paper onto the WoolFelt, pressing down for a few seconds until the freezer paper sticks.
- Cut the pattern pieces out of the WoolFelt in the following quantities:
 - From the Moss WoolFelt, cut one head/ neck unit.
 - From the Black WoolFelt, cut one hair, one mouth, two eyebrows, two bolts, and one piece measuring 1" x ¼". Then cut the 1" piece into four ¼" squares for the inner eyes and nostrils.
 - From the Old Gold WoolFelt, cut two outer eyes, and the lightning bolt.
- Use the glue stick to adhere smaller applique pieces before stitching.
- Use three strands of matching floss for all stitching. (Note that all stitching is shown in white or black but should be sewn in floss that matches the WoolFelt colors.)

Prepare the Frankenstein Head

- Position the hair on top of the head, lining up the top edges as shown in Figure A. Pin securely, or tack down with glue stick. With matching floss, sew just inside the bottom edge of the hair only with a running stitch. (See Figure A; stitches shown in white.)
- Position the eyebrows $\frac{3}{4}$ " down from the hair, and $\frac{1}{2}$ " in from the side edges of the head as shown in Figure B. Tack down with glue stick. With matching floss, sew down the center of each brow with a running stitch. (See Figure B; stitches shown in white.)

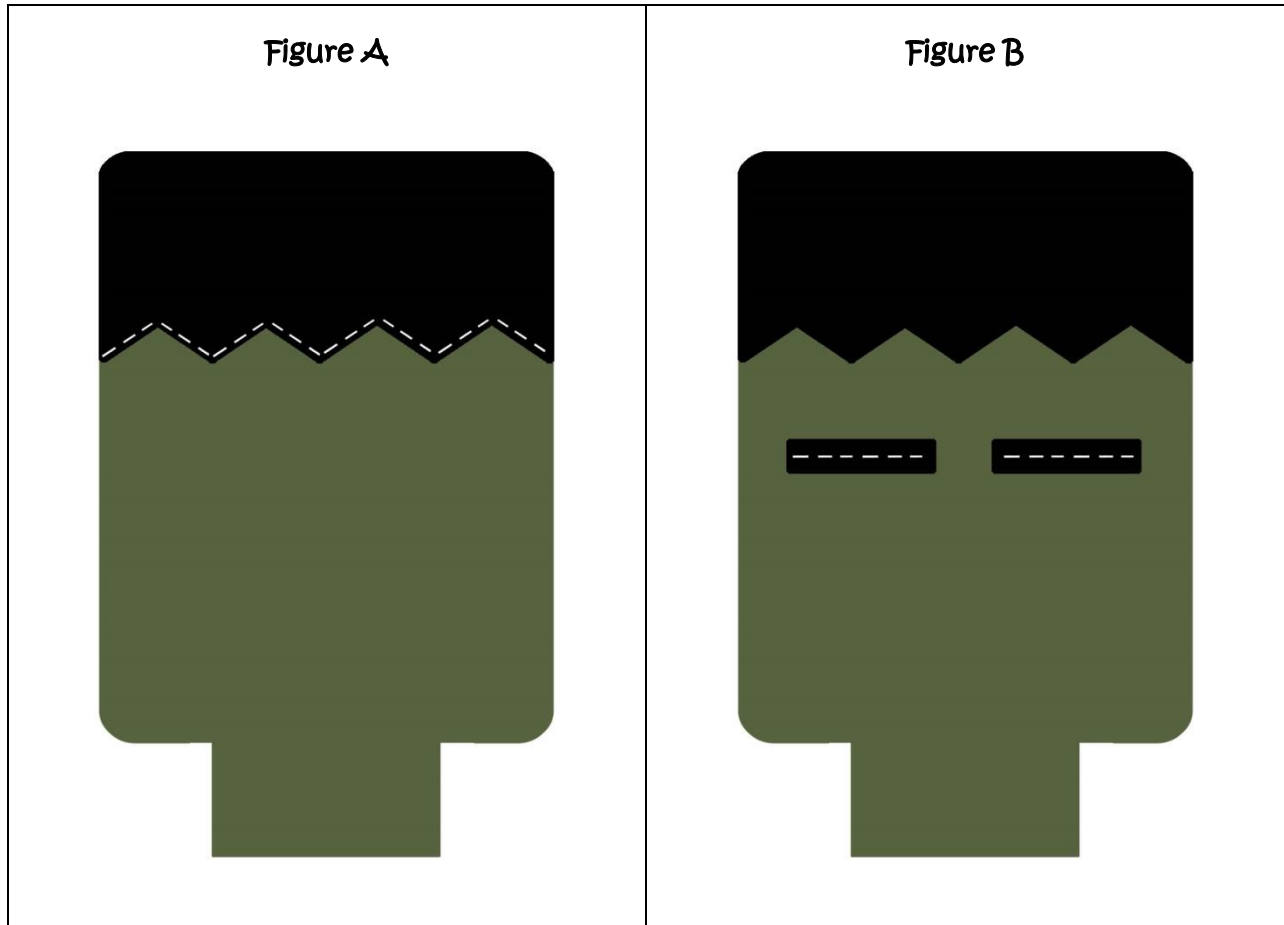

- Place the inner eyes on the outer eyes and tack in place with glue stick. Sew down with matching floss and an “X” across the eye (stitches shown in white in Figure C). Then position the eyes on the head centered under each eyebrow as shown in Figure C. With matching floss, blanket stitch around the outer eyes, sewing them to the head. (See Figure C; stitches shown in white.)
- Position the mouth $\frac{3}{4}$ ” beneath the eyes, and centered horizontally on the head as shown in Figure D. Pin or tack in place with glue stick. With matching floss, blanket stitch around the mouth. (See Figure D; stitches shown in white.)

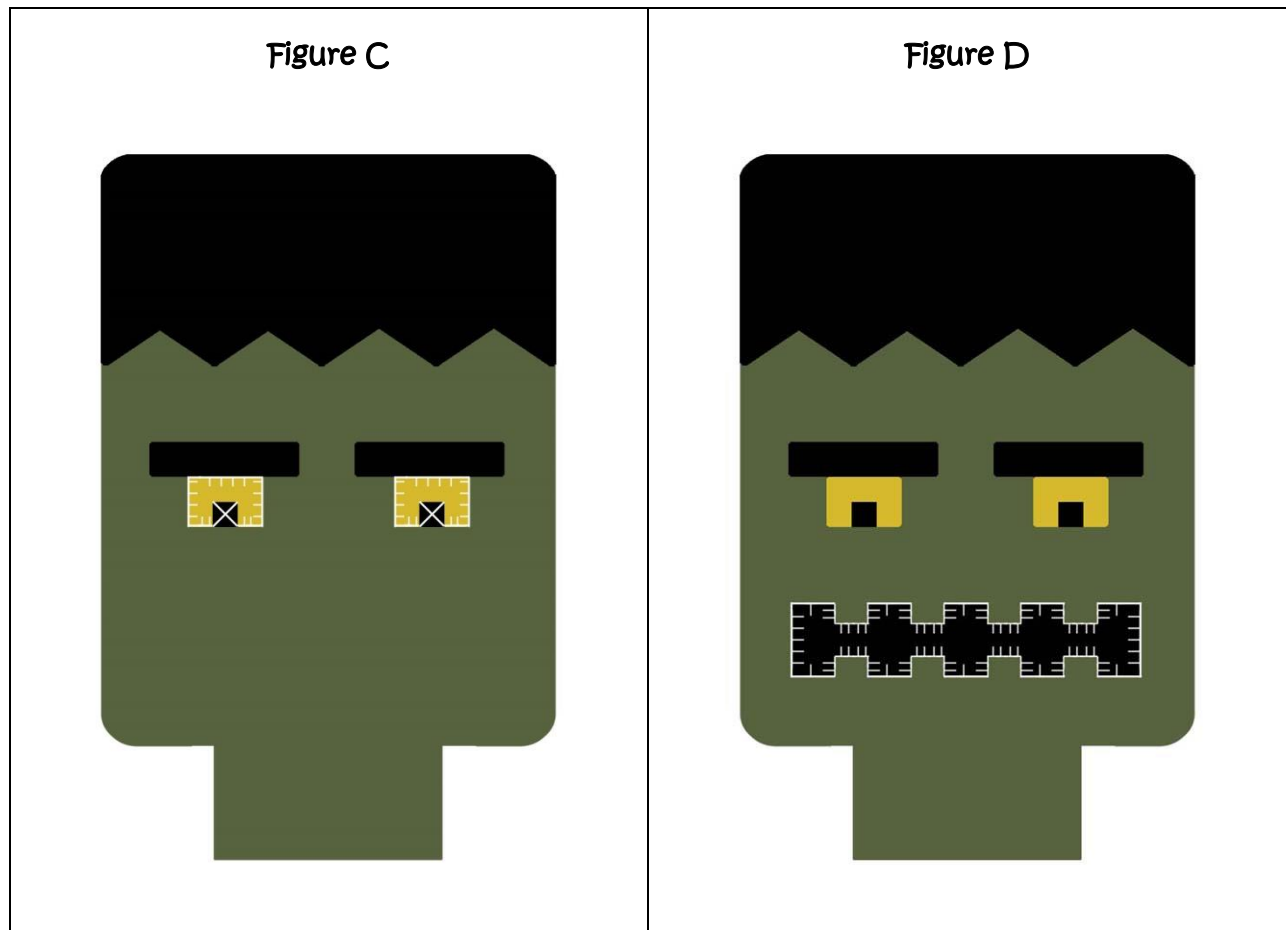

- Position the nostrils between the bottom of the eyes and the top of the mouth, and centered horizontally on the head as shown in Figure E. Tack in place with glue stick. With matching floss, sew down with an “X” across each nostril. (See Figure E; stitches shown in white.)

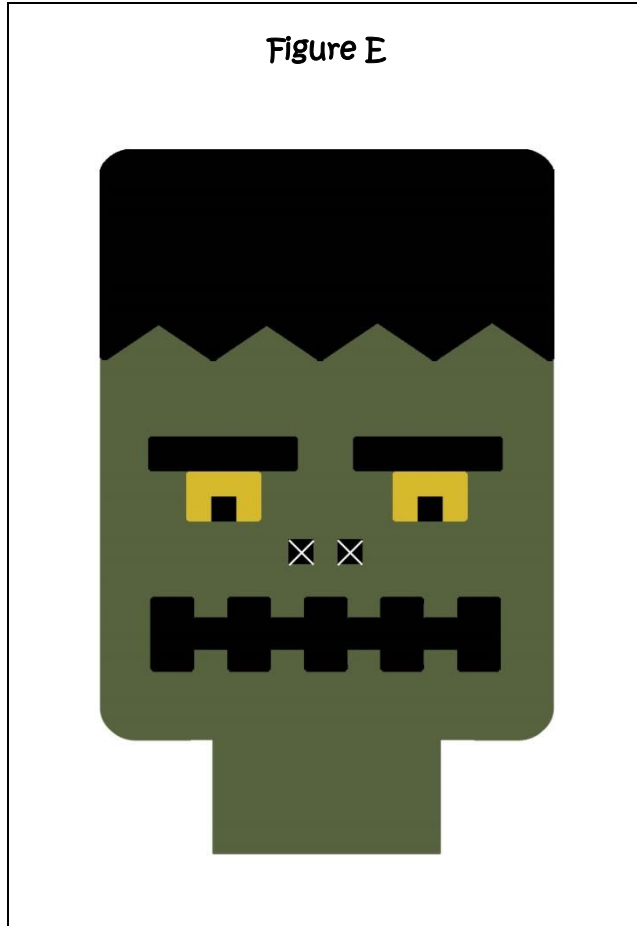

Assemble Mug Rug

- Position the completed Frankenstein head on the 9" x 12" Field of Lilacs WoolFelt background piece as shown in Figure F. Pin securely in place.

Figure F



- With matching floss, blanket stitch around the outside of the hair area only as shown in Figure G, (stitches shown in white).

Figure G

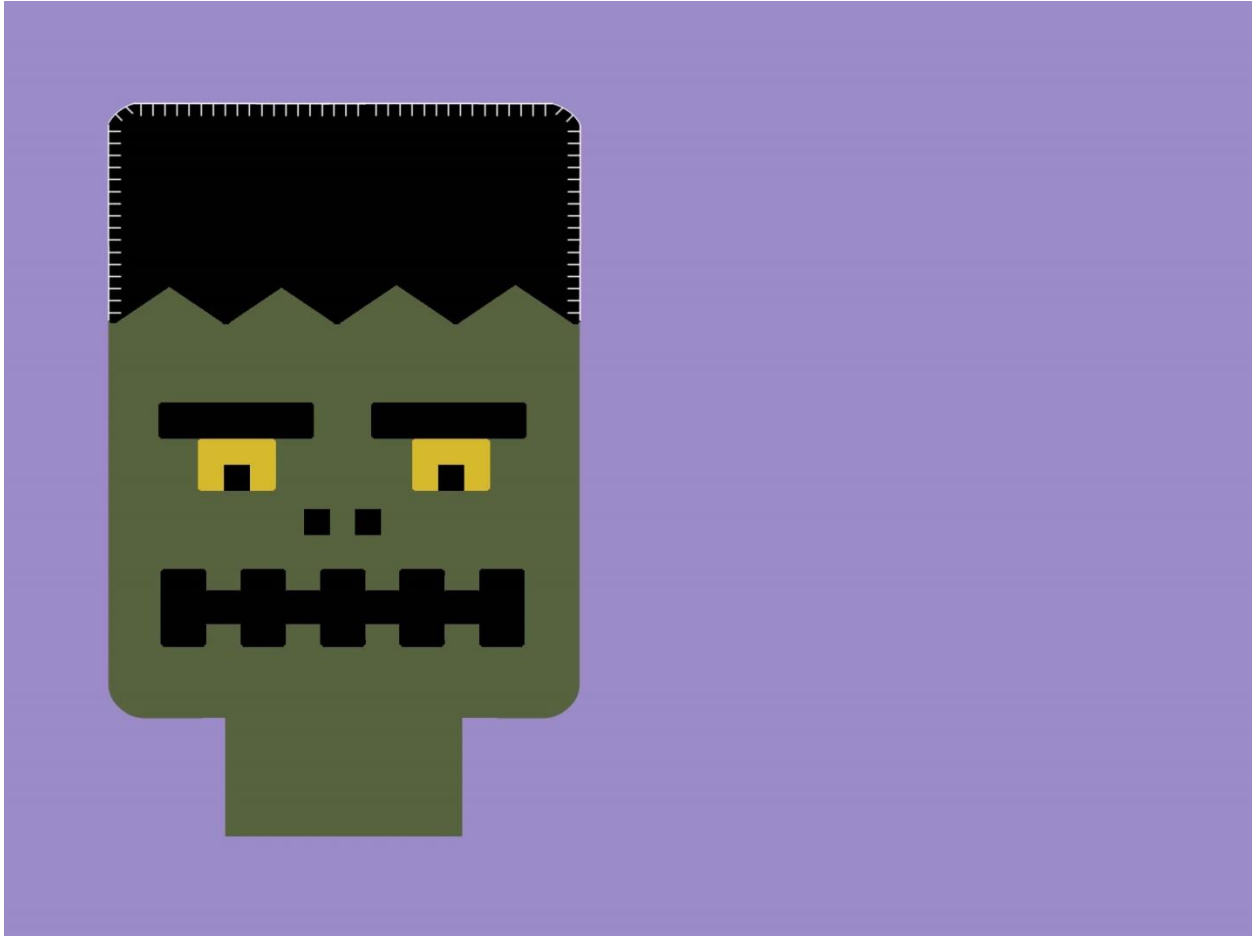

- With matching floss, blanket stitch around the remainder of the head/neck unit as shown in Figure H, (stitches shown in white).

Figure H

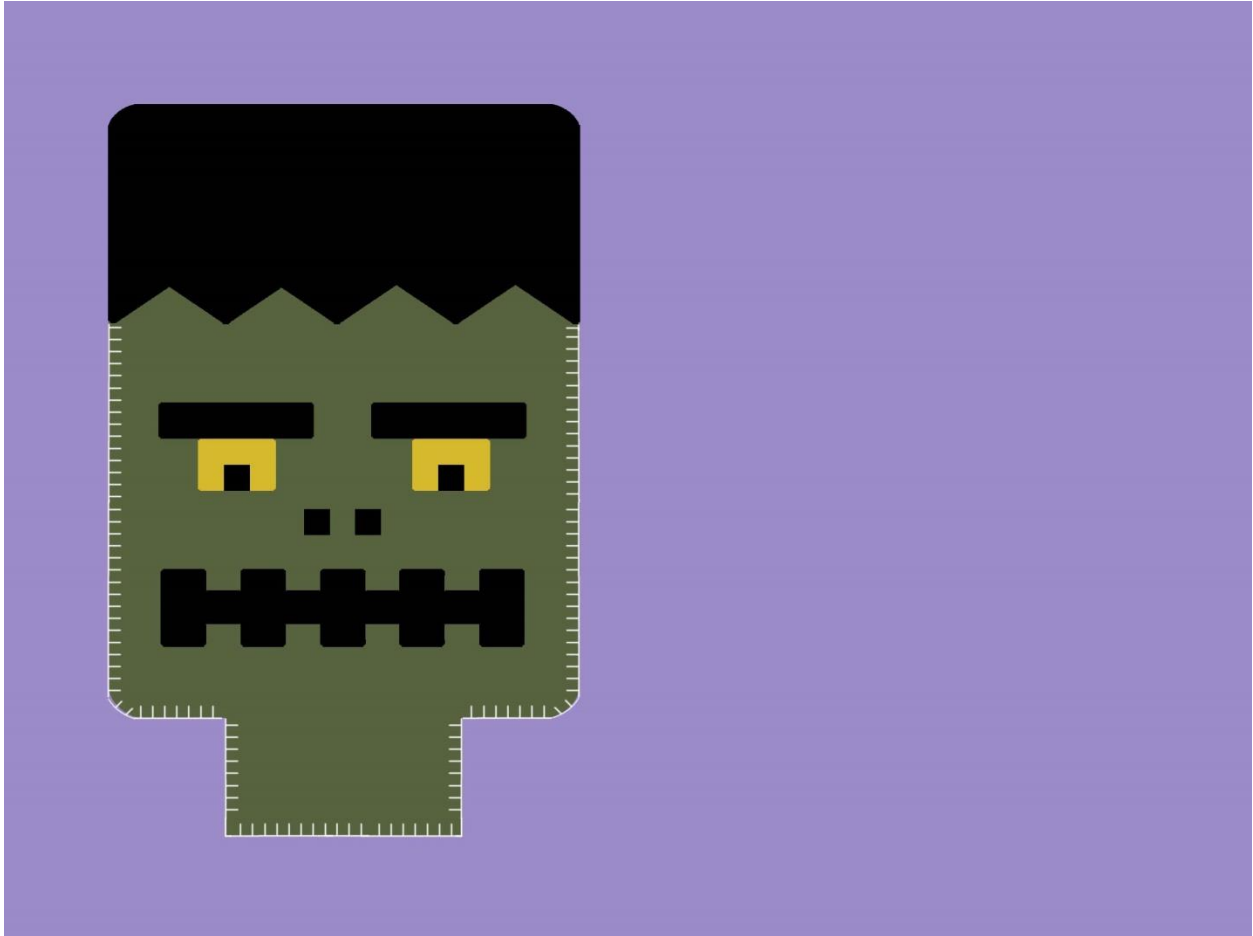

- Position the bolts on the sides of the neck as shown in Figure I. Tack in place with glue stick. With matching floss, blanket stitch around each bolt. Interlock the stitches with those of the neck where they meet. (See Figure I; stitches shown in white.)

Figure I

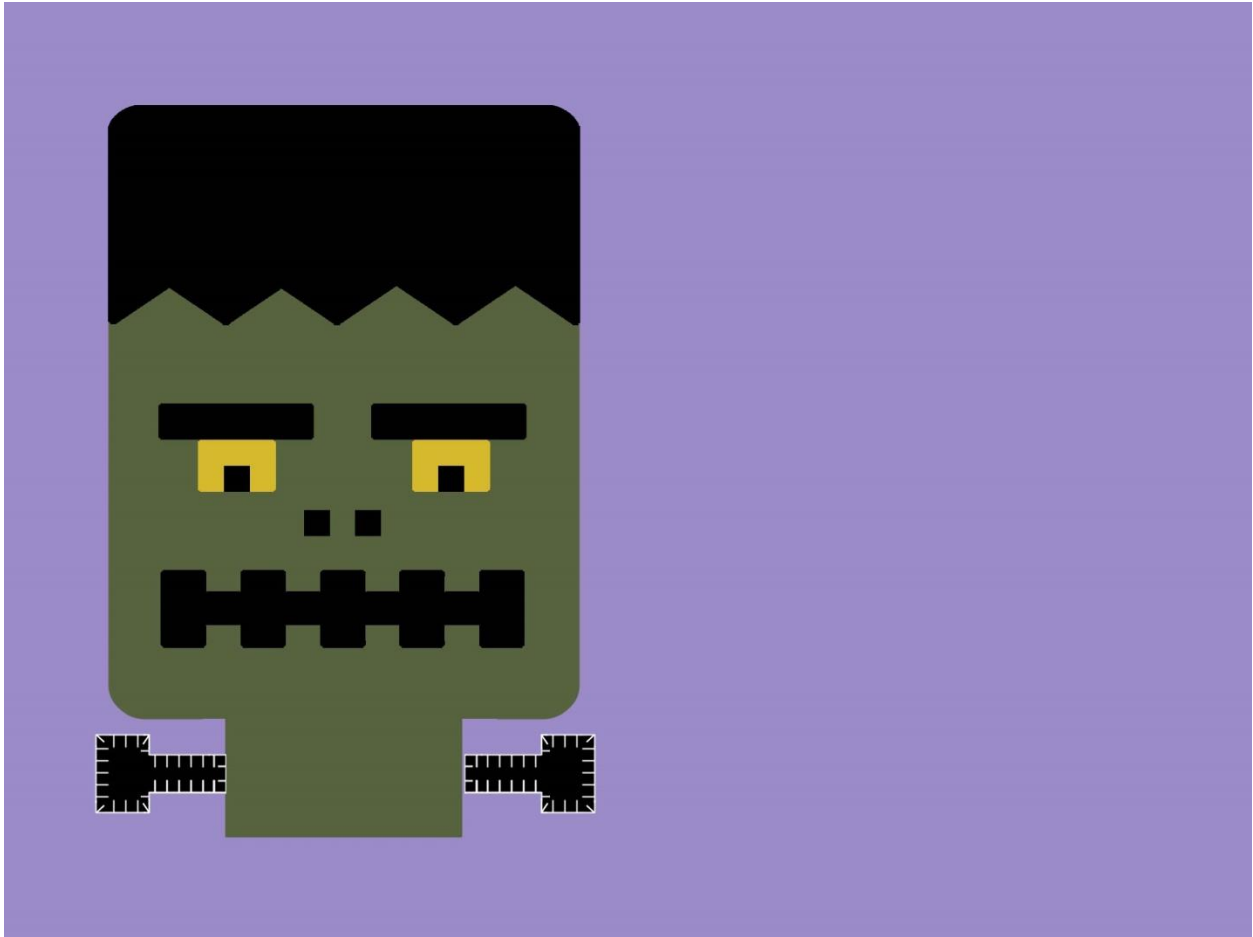

- Position the lightning bolt as shown in Figure J. Tack in place with glue stick. With matching floss, blanket stitch around the lightning bolt. (See Figure J; stitches shown in black.)

Figure J

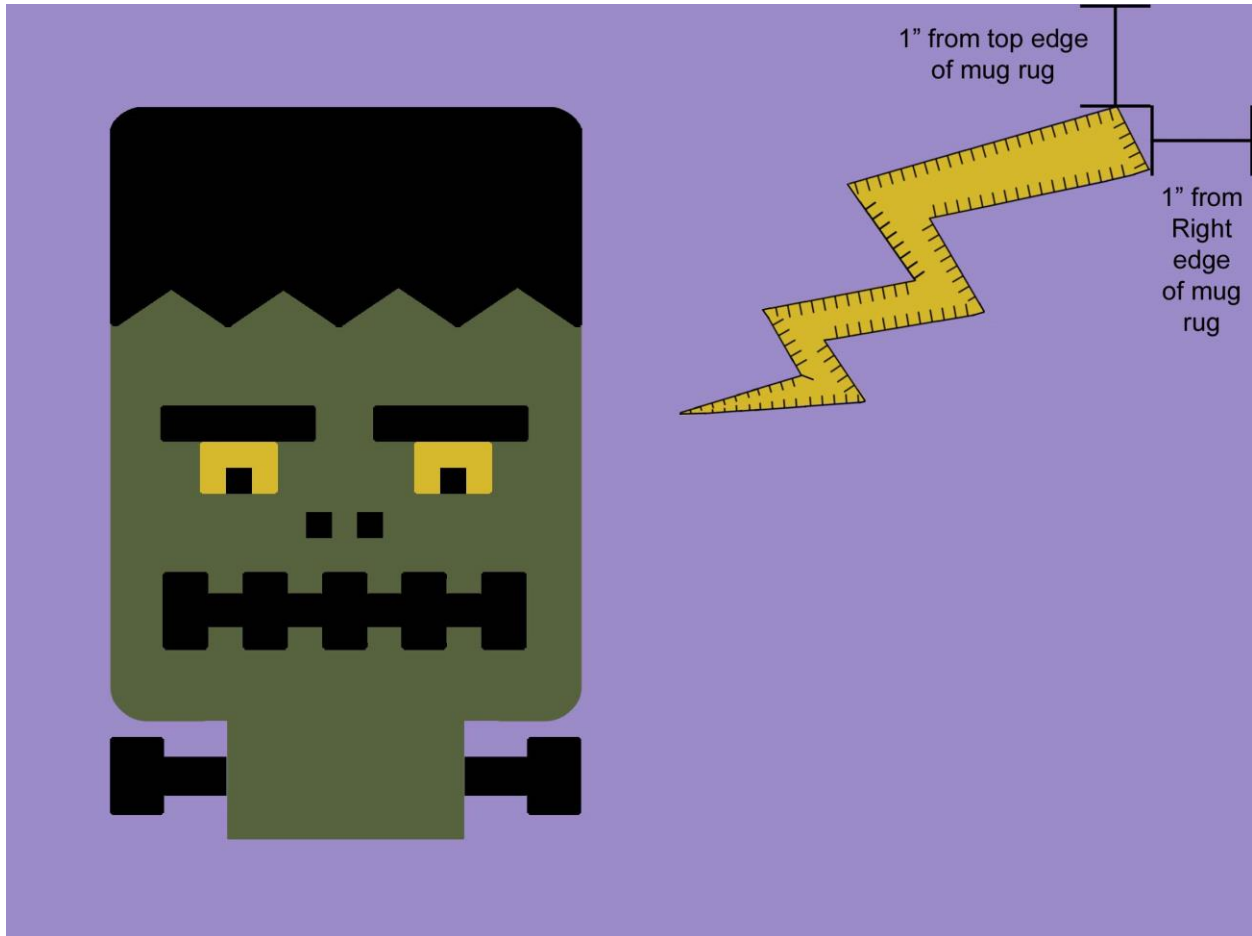

- Press the appliqued mug rug top with an iron on the wool setting.
- Layer the reserved 9" x 12" Field of Lilacs WoolFelt piece behind the completed mug rug top. Pin layers securely. With matching floss, blanket stitch around the entire perimeter of both layers as shown in Figure K, (stitches shown in black).

Figure K

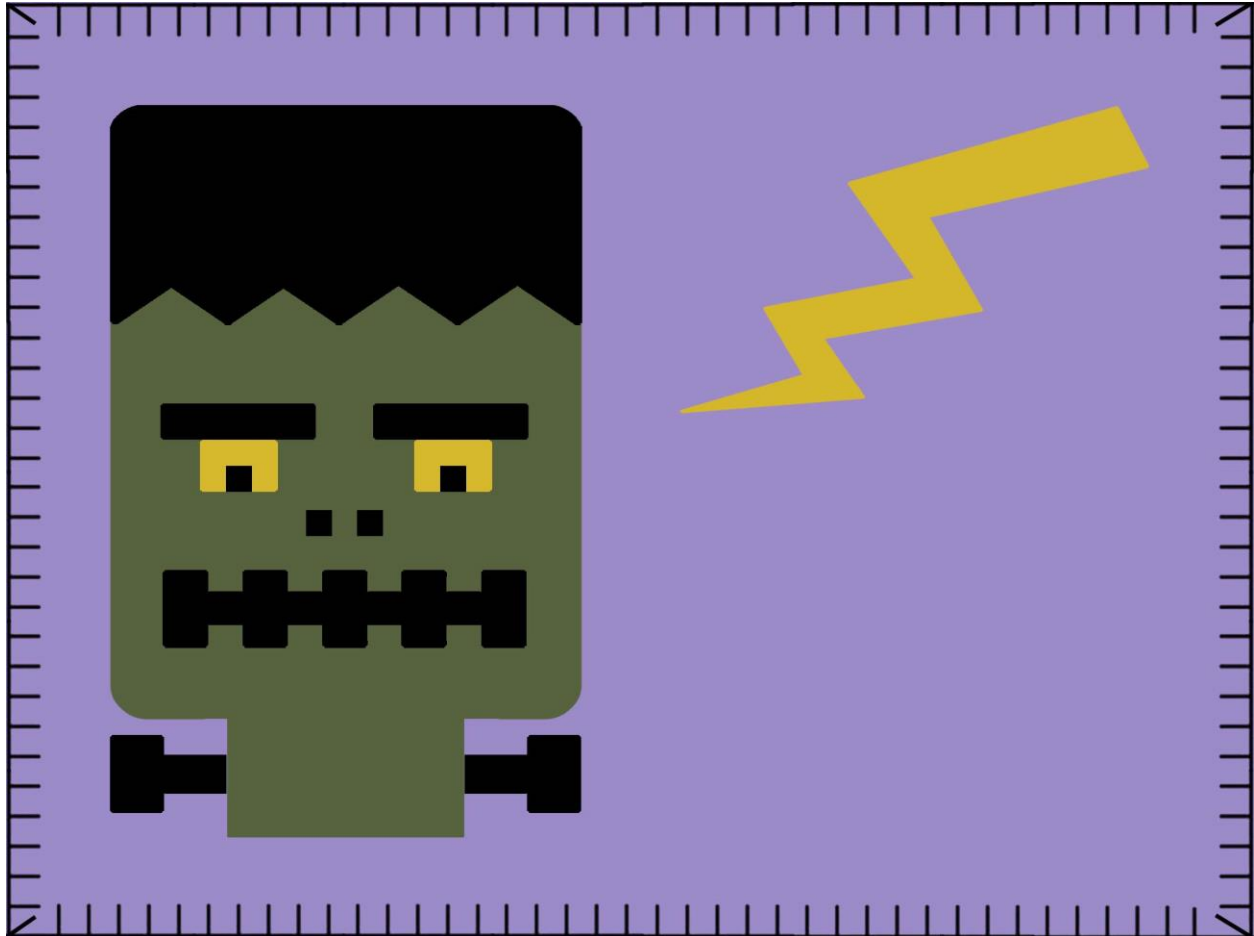

- Press the finished mug rug with an iron on the wool setting.
- The finished mug rug measures approximately 9" x 12".
- For questions regarding this project, please contact Elizabeth at ecoughlin@comcast.net

Stitch Diagrams

Blanket Stitch

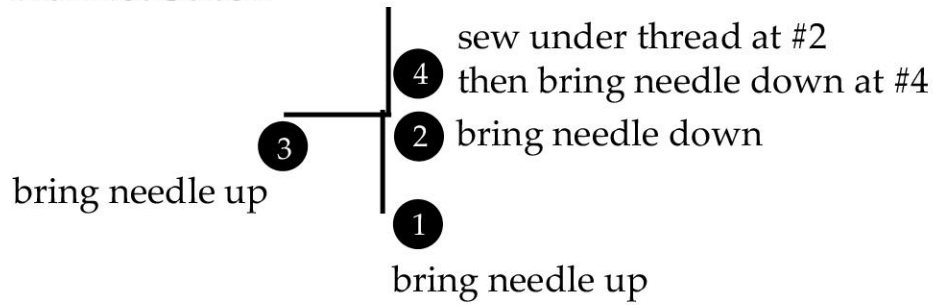

Running Stitch

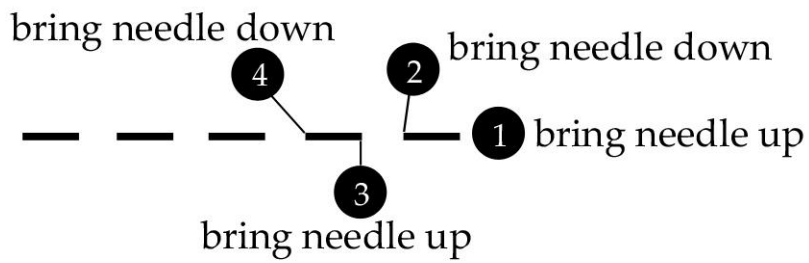



Outer Eyes
cut two



Brows cut two

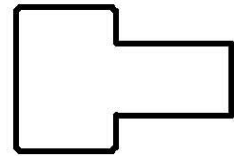

Bolts cut two

